

UK-50 UNDERGROUND DUMPER TRUCK

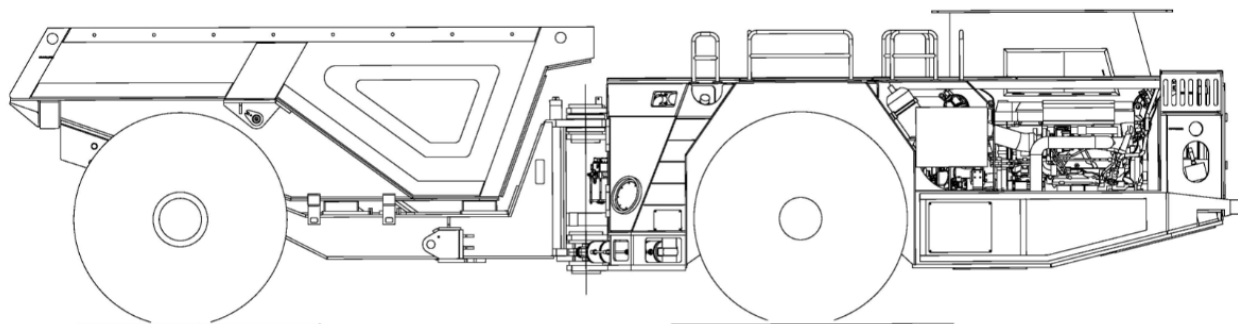

Main features

- USA power shift transmission and converter
- Integrated service brake, parking brake, and emergency brake; Safety spring brake and hydraulic release system.
- Integrated steering and working hydraulic system can highly improve the working efficiency
- Central articulated system, with two cylinder support steering, make the machine much more stable;
- Two cylinder lifting the wagon box.
- Backboard for protect the rocks from falling off when travelling;
- Forward seating
- Protections for hoses and engine compartment for extremely cold area in winter time.

Main parameter

Model	UK-50	
L*W*H	11500mm×3500mm×(2880mm~3000mm)	
Wagon box volume	23.5 m ³ or designed to rock density	
Rated loading capacity	50 Metric Ton	
Tare weight	42 900 Kgs	
Engine power	565KW/700 HP	
Maximum Torque output	2 983 Nm @ 1 500 rpm	
Travelling speed	0~30.8 km/h	
Maximum steering angle	±42°	
Turning radius (mm)	Internal	5100
	External	9500
Wagon box lifting/descend (s)	14/10	

Wagon box tilting height (mm)	6455
Wagon box off load angle	62°
Grade ability	20%
Tires	35/65, R33

Main components and supplier:

➤ **Engine:**

Manufacturer: VOLVO PENTA
 Model: TAD1643VE-B
 Power: 565 KW/19 00rpm
 Maximum torque: 3260 Nm @ 1 260 rpm

Options:

Manufacturer: Cummins
 Model: Cummins QSK19 EPA Tier 3
 Power: 522kw/700 HP@2000rpm
 Maximum torque: 2 983 Nm @ 1 500 rpm

➤ **Axle:**

Manufacturer: Kessler
 Model: D106 for front and rear axles
 Brakes: SAHR on four wheels, spring brake hydraulic release
 Type: Enclosed wet multiple discs brake

➤ **Transmission:**

Manufacturer: Allison
 Model: 6620AR

➤ **Hydraulic system:**

Main pump: Parker
 Braking valve: MICO

➤ **Electric system: 24V DC**

Options:

1. Sealed cabin with air-conditioner and heating system, with Video and USB port for amusement;
Ergonomically and spacious designed compartment for safety and easy operations;
3 POP-UP window for easy access when facing emergencies;
Rain scraper for front window
Protection for front window from falling rocks;
FOPS and ROPS standard
2. Travelling aid system with camera and record of operation for one month;
3. Automatic and manual fire suppression system for engine compartment;
4. Automatic central lubrication system

Dimensions

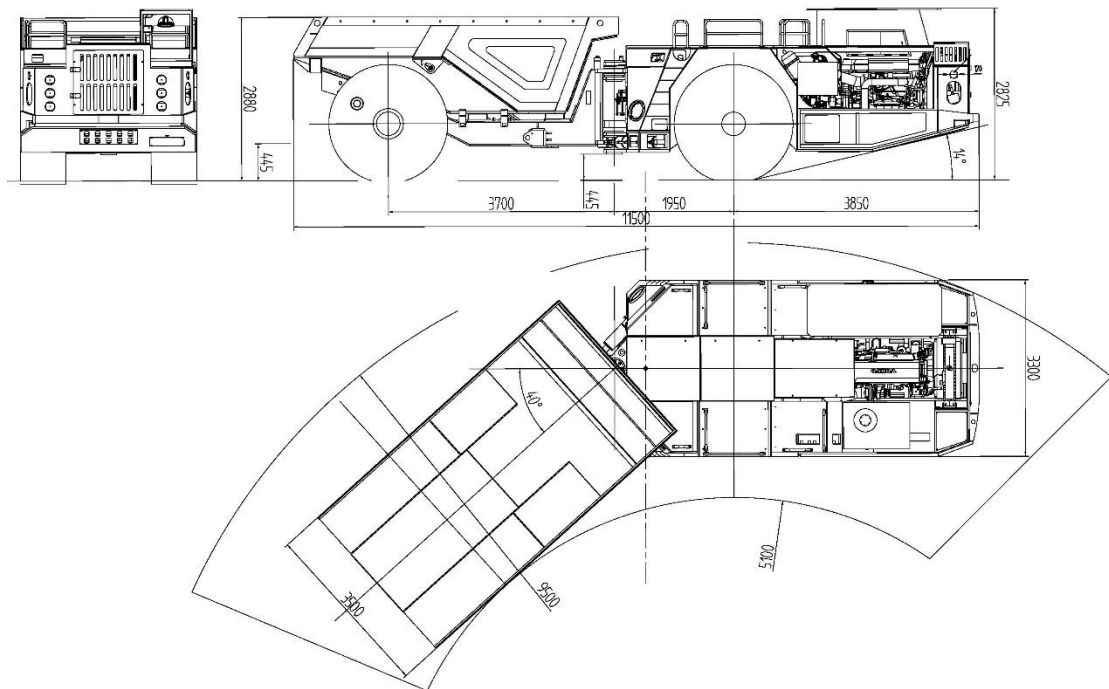

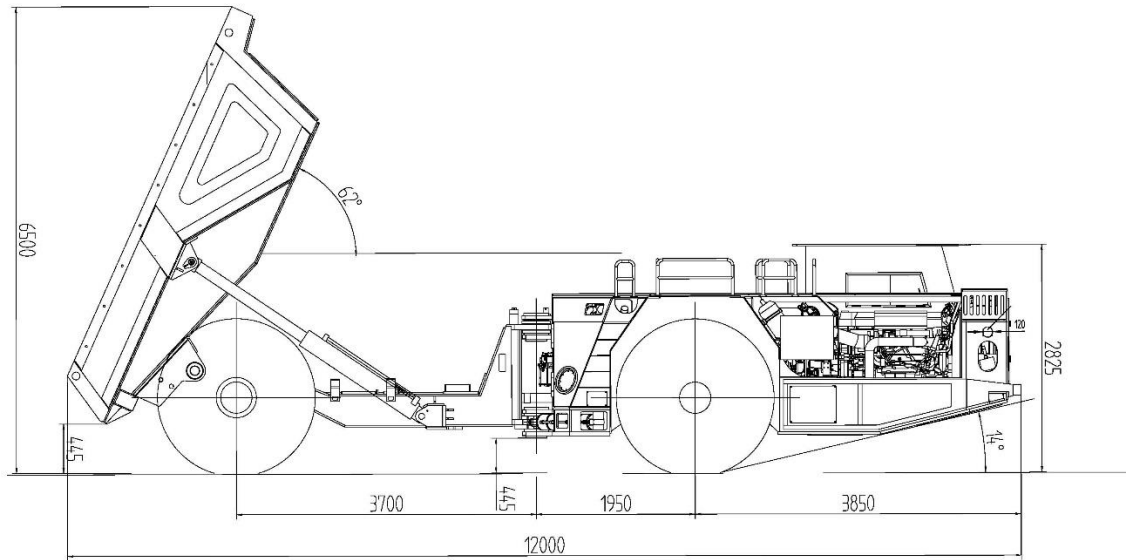

Please consult our local dealers for services, you can also contact us directly any time to make consultancy!