

## WJD-2 ELECTRIC UNDERGROUND LOADER



Central articulated frame, Z-line boom, Hardox 500 cutting blade, limited differential lock.

### Main technical details

Rated bucket capacity (SAE): 2 ~ 2.4 m<sup>3</sup>

Rated loading capacity: 5000 kg

Max. traction force: 102kN

Max break-out force: 95 kN

### Travelling speed

1st gear : 0 ~ 2.9 km/h

2nd gear: 0 ~ 6.0 km/h

3rd gear: 0 ~ 10.2 km/h

### Turning radius

Turning radius (Bucket external): 5800 mm

Turning radius (Rear wheel inner): 3300 mm

Max. unloading height: 1800 mm

Max. unload angle: 40°

Minimum unload distance: 880 mm

Ground clearance: 300 mm

Motion time (LHD): 18 sec

Grade ability (full load): 14°

Steering angle: ±36°

Operation weight: 14500 kg

### External dimensions

Length x Width x Height (Transportation): 7950mm x 1960mm x 2250mm

## Power Train

Electric motor: Y2-280S-4 90KW  
Power voltage: 380V /50Hz; 24V control voltage  
Insulation grade: H-class  
Protection grade: IP65

## Transmission system

Torque converter: DANA/ C270  
Transmission: DANA/R32000  
Driving axle CY-2JD/E (T) Wet- multi-discs spring-brake rigid axle  
Rear axle oscillating:  $\pm 8^\circ$   
Tire size: 14.00-24-24 smooth surface anti-cut type  
Rim size: 10.00-24 (FB)

## Braking system

Operation brake: multi-discs spring brake hydraulic release  
Braking pump : Permco  
Braking valve: Mico hydraulic valve  
Parking brake: wet multi-discs spring brake hydraulic release

## Steering system: central articulated frame, hydraulic power steering

All hydraulic steering device: Eaton  
Pilot valve: Eaton  
Steering cylinder: D100/d55E

## Operation hydraulic system

Type: pilot valve control  
Operation pump: Permco gear pump  
Hoisting cylinder: D140/d80E  
Tilting cylinder: D180/d90 E  
Multiple directional valve: SD25/2

## Reel system: automatic reel valve

Reel motor for cable: swinging motor  
Cable length: 120m Electric cable

## Electrical system

Power supply: working 380V, control 24V  
Other device: insulation device, electric motor over-load protection  
Illumination: Front lamp (LED) 2pcs, 18W,24V  
Rear lamp (LED) 2 pcs, 18W,24V

## Dis-assemble size and weight

Maximum dis-assembled components size: 4450X1850X1315

Maximum dis-assembled components weight: 8100 kg

## Diesel and hydraulic oil volume

Travelling oil tank: 25L 6# hydraulic oil

Hydraulic oil tank: 180L, L-HM68 anti-wearing hydraulic oil

**Tunnel applicable :** 3000mmX3500mm

**Hose and connectors:** Quick release

**Dimensions:**

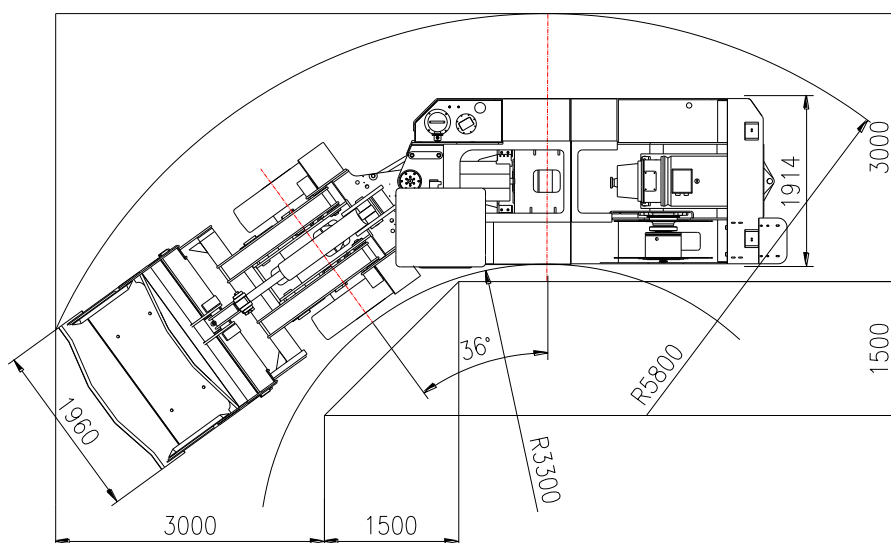
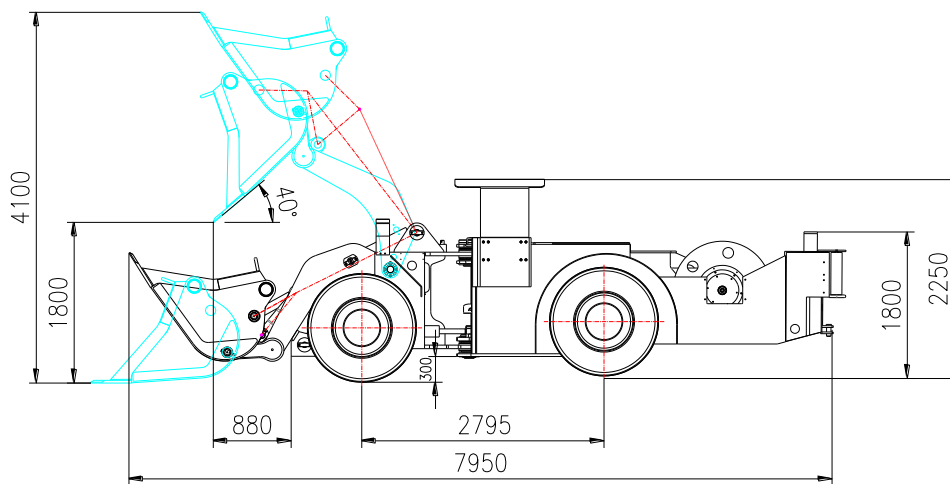

## Tools and components with delivery

Parts with delivery free of charge

S/N	Name of parts	Qty	S/N	Name of parts	Qty
1	Fuel filter element	1	16	O-ring seal M45X2	5
2	Hydraulic oil suction Filter element	1	17	Gasket 10	5
3	Hydraulic oil filter element	1	18	Gasket 12	5
4	Pull pin	2	19	Gasket 14	5
5	Seal gasket B100X130X12	2	20	Gasket 16	5
6	Insulation box	1	21	Gasket 18	5
7	Travelling filter element	1	22	Gasket 20	5
8	Oil cup M10X1	5	23	Gasket 22	5
9	Oil seal PD140X170X16	1	24	Gasket 24	5
10	O-ring seal M16X1.5	5	25	Gasket 27	5
11	O-ring seal M18X1.5	5	26	Gasket 30	5
12	O-ring seal M20X1.5	5	27	Gasket 33	5
13	O-ring seal M22X1.5	5	28	Gasket 36	5
14	O-ring seal M30X2	5	29	Operator's manual & Parts Catalogue	1
15	O-ring seal M36X2	5	30	Product QC certificate	1

## Tools with delivery

S/N	Name of tools	Qty	S/N	Name of tools	Qty
1	Grease gun	1	15	Inner Hex wrench S=4	1
2	Lubrication oil tun	1	16	Inner Hex wrench S=5	1
3	straight tip shaft circlip pliers	1	17	Inner Hex wrench S=6	1
4	straight tip hole circlip pliers	1	18	Inner Hex wrench S=8	1
5	socket plier S=50	1	19	Inner Hex wrench S=10	1
6	tire plier S=36	1	20	Inner Hex wrench S=12	1
7	S=9/16 double end wrench	1	21	Inner Hex wrench S=14	1
8	double end wrench S=3/4	1	22	Pressure gauge 0~10MPa	1
9	double end wrench S=12/14	1	23	Pressure gauge 0~25MPa	1
10	double end wrench S=17/19	1	24	PTB-H3/P1-25-500	1
11	double end wrench S=22/24	1	25	Key	2
12	double end wrench S=27/30	1	26	CQJ-25 air charger	1
13	double end wrench S=32/36	1	27	Pressure gauge connector	1
14	double end wrench S=41/46	1			