

## WJ-6 UNDERGROUND WHEEL LOADER



### 1. 整机技术参数 Technical Specifications

● 额定载重量:		14 Metric Ton
Rated loading capacity:		
● 斗容量 (堆装):		6 m <sup>3</sup>
Bucket volume ( SAE)		
● 最高行驶速度	I 档:	3.9 km/h
	II 档:	7 km/h
	III 档:	12.3 km/h
	IV 档:	22 km/h
Travelling speed:		
	Gear I :	3.9 km/h
	Gear II:	7 km/h
	Gear III:	12.3 km/h
	Gear IV:	22 km/h
● 工作时间:		18 s
Time: Lift+Dump		
● 最大爬坡能力 (重载):		25%
Grade ability ( Full load)		
● 最大牵引力:		350 kN
Maximum traction force:		
● 转弯半径:	内侧	3519 mm

外側	7100 mm
Turning radius: Inner 3519 mm	Outer 7100 mm
● 卸载时机器最大高度:	5779 mm
Maximum machine height when unload:	
● 最大卸载角度:	40°
Maximum unload angle:	
● 转向角:	±40°
Steering angle:	
● 最小离地间隙:	350 mm
Ground clearance:	
● 外形尺寸 (长×宽×高): 10600 mm×2866 mm×2500 mm	
Dimensions when transport (L×W×H):	
● 整机操作重量:	40 t
Operation weight: 40 Metric Ton	

## 2. 发动机 Engine

- 发动机: VOLVO TAD1350VE 水冷式低污染发动机,  
Engine: VOLVO TAD1350VE water-cooled low pollution diesel engine, EUIII emission standard
  - 额定功率/额定转速: 256 kW/1900 r/min  
Rated power/rpm:
  - 最大输出扭矩: 2175 N·m@1200 r/min  
Maximum torque output:
  - 启动方式: 电启动  
Starting method: electric start
  - 废气净化方式: 催化净化法  
Exhaust purifying method
  - 油门控制: 威廉姆斯电控油门控制器  
Throttle controller: Williams
- 选装: SCANIA DC13 076A @ 257 kW/2100 rpm  
Опции: SCANIA DC13 076A @ 257 kW/2100 rpm

## 3. 传动系统 Transmission system

- 变速箱型号: 6000  
Transmission: DANA 6000 SERIES
- 变矩器型号: CL8000  
Converter: DANA CL8000 series
- 驱动桥型号: KESSLER 106 总速比: 30.2

Drive axle: Kessler+CO D106

- 轮胎: 充气轮胎

Tires: smooth surface cut resistance tires

## 2.4. 制动系统 Brake system

- 工作制动泵排量: 75/33ml/r

Operation brake pump displacement:

- 系统最高压力: 20 MPa

System peak pressure:

- 行车制动: 湿式多盘弹簧制动器

制动阀型号: MICO 03-460

松闸压力: 128 bar

Travelling brake: wet-multi-discs spring brake hydraulic release

Brake valve: MICO 03-460

Brake release pressure: 128 bar

- 驻车制动: 驱动桥上弹簧制动器

弹簧制动、液压松闸

Parking brake: Spring brake on drive axles

Type: spring brake hydraulic release (SAHR)

## 5. 转向系统 Steering device

- 型式: 中央铰接、液压转向

Type: central articulation, hydraulic steering

- 转向工作泵 排量: 75ml/r

Steering pump displacement: 75ml/r

- 转向系统最高压力: 20 MPa

Steering system peak pressure: 20 MPa

- 转向油缸缸径/杆径×缸数:  $\phi 150/\phi 90 \text{ mm} \times 2$

Steering cylinder DIA/rod DIA×qnty:  $\phi 150/\phi 90 \text{ mm} \times 2$

## 6. 工作系统 Operation system

- 举升油缸缸径/杆径×缸数:  $\phi 160/\phi 100 \text{ mm} \times 2$

Lift cylinder DIA/rod DIA×qnty:  $\phi 160/\phi 100 \text{ mm} \times 2$

- 翻斗油缸缸径/杆径×缸数:  $\phi 260/\phi 160 \text{ mm} \times 2$

Tilting cylinder DIA/rod DIA×qnty:  $\phi 260/\phi 160 \text{ mm} \times 2$

- 工作系统最高压力: 24MPa

Operation system : 24 MPa

## 7. 电气系统 Electric system

- 系统电压: 24V 直流

System voltage: 24VDC

- 启动马达电压/功率: 24V/7.5kW

Starter motor Vol/Power: 24V/7.5kW

- 照明: 前大灯 2 个, 2×42W, 24V

Illumination: Front work light: 2×42W, 24V

后大灯 2 个, 2×42W, 24V

Rear work light: 2×42W, 24V

驾驶室顶灯 2 个, 2×18W, 24 V

Ceiling light: 2×18W, 24 V

## 2.8. 油箱容积 Liquid fill in

- 液压油箱: 540 L

Hydraulic oil tank: 540 L

- 燃油箱: 450 L

Diesel tank: 450 L

- 变速箱: 32 L

Transmission oil: 32 L

- 驱动桥主传动部分: 36L×2

Main differential :

- 驱动桥轮边减速部分: 6.5 L×4

Drive axle end differential:

- 发动机润滑油: 38L

Engine lubrication oil:

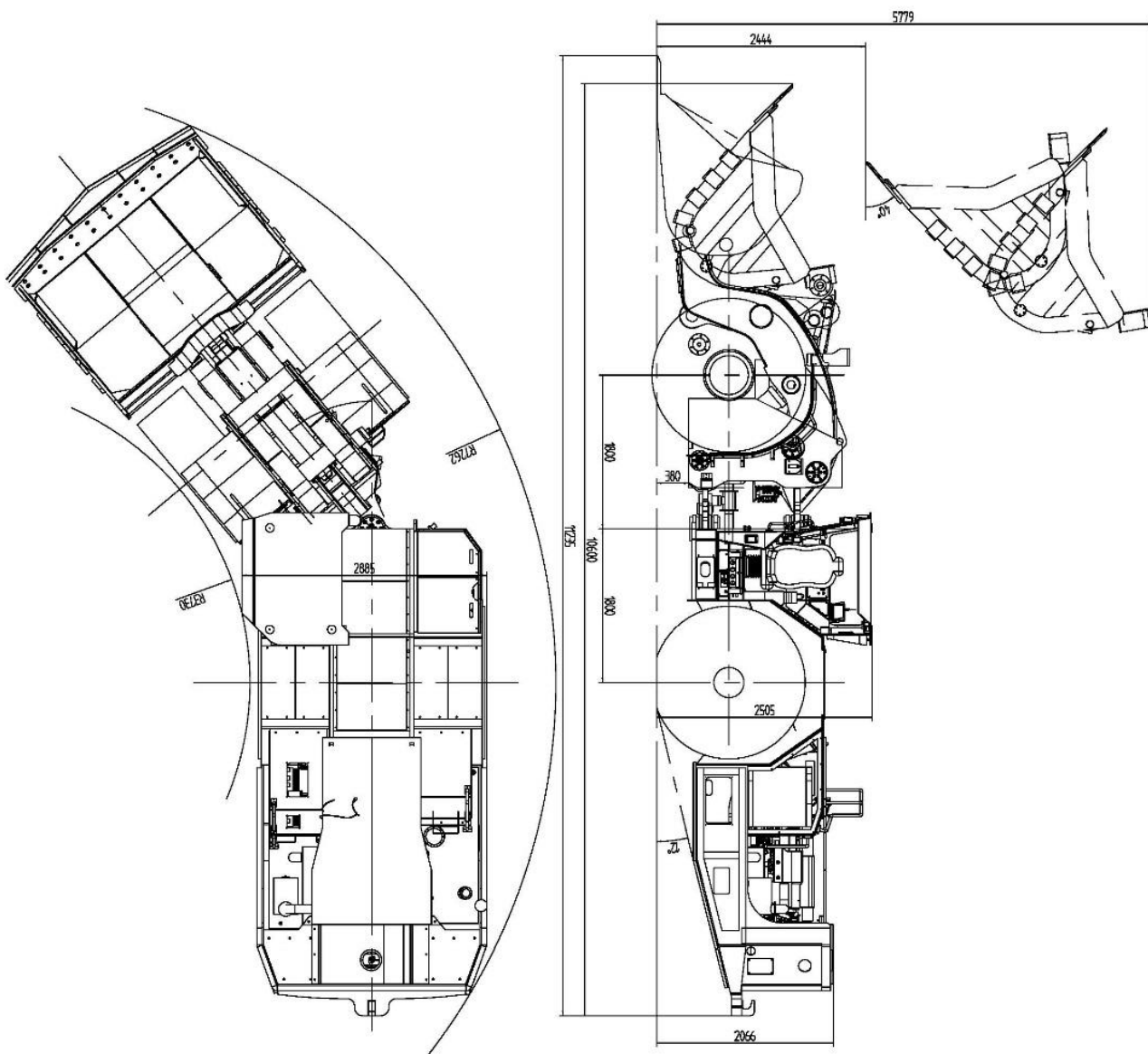



PHOTO GALLERY:

