

## WJ-1.5G UG PRODUCTION LOADER

WJ-1.5G UG production loader is central articulated frame underground wheel loader, with S-shape self-balancing structure boom, Cabin set on the rear part of the chassis with FOPs+ROPs open cabin. Wear-resistance shovel blade and side blade from Sweden. NO-SPIN for front axle;

Main Specifications	
Rated bucket volume (SAE)	1.5 m <sup>3</sup>
Rated loading capacity	3 Metric Ton
Maximum traction force	80kN
Maximum shovel force	70 kN

Travelling speed	
1st Gear	0~3.2
2nd Gear	0~6.5
3rd Gear	0~14

Action time	
Hoist	4.8 sec
Descend	2.7 sec
Tilt	1.6 sec

Weight	
Empty weight	10.5 Metric Ton
Weight with full load	13.5~13.8 Metric Ton

Dimensions	
Length (transport)	6820 mm
Width (blade external)	1640 mm
Height (body)	1518 mm
Height (roof)	2100 mm
Wheel base	2510 mm
Tread	1315 mm
Rear axle oscillate	±6°
Maximum unload height	1350 mm
Unload distance	1025 mm
Unload angle	40°

Turning radius	
External ( blade external)	5000 mm
Inner (rear wheel inner)	2890 mm

Grade ability	
Maximum grade ability (full load)	14°

## MAIN COMPONENTS

Power-train	
Brand	Germany Deutz
Model	F6L912W
Type	Air-cooled diesel engine
Rated power	63 KW @ 2300 rpm
Fuel consumption	230 g/kW-h
Air-intake	Import Donaldson air filter
Exhaust	Catalytic purifying + silencer

Drive line	
Transmission	DANA R20000 series
Converter	DANA C270 series
Drive Axle	CY-1.5
ratio	26.11
Front axle	NO-SPIN
Tire size	12.00-24-16
Inflation pressure	670 kPa
Rim size	8.5"

Brake system	
Service brake	dual circuit, wet-multiple discs with spring pressured ,hydraulic release
Parking brake	Caliper disc brake on transmission
Valves	Import brand valve

Steering system	
Type	All hydraulic power steering
Steering cylinder	D90/d45E ×2
Swing angle	±38°

Service hydraulic system	
Type	Hydraulic pilot valve controlling
Service pump	P4800 gear pump
Hoist cylinder	D125/d63 E ×2
Tilt cylinder	Qty D150/d85 E ×1
Multi-directional valve	ZL25E

Electric system	
Working voltage	24VDC
Starter motor	BOSCH 3.6KW/24V
AC generator	BOSCH 28V/35A
Battery	2×12V (120Ah)

Electric system	
Engine oil temperature	Engine oil pressure
Hydraulic oil temperature	Engine oil level
Engine cylinder head temperature	Hour meter
Transmission oil temperature	Tachometer
Reverse alarm and warning	Ammeter

Safety regulations	
Working temperature	≤40°C
Cabin	FOPs+ROPs standard
Design standard	GB/T5143



**WILLIAMS**  
Valve Corp.

Liquid volume	
Engine oil	19 Liter (to oil stick down level)
Diesel	180 Liter
Transmission oil	34 KG 6#, 8# hydro-power oil
Hydraulic oil	180 KG #68 anti-wear hydraulic oil
Drive axle main differential	12 liter;
Wheel side reducer	3.5 liter per each
Lubricant	GL-4 85W/90W

## Main options:



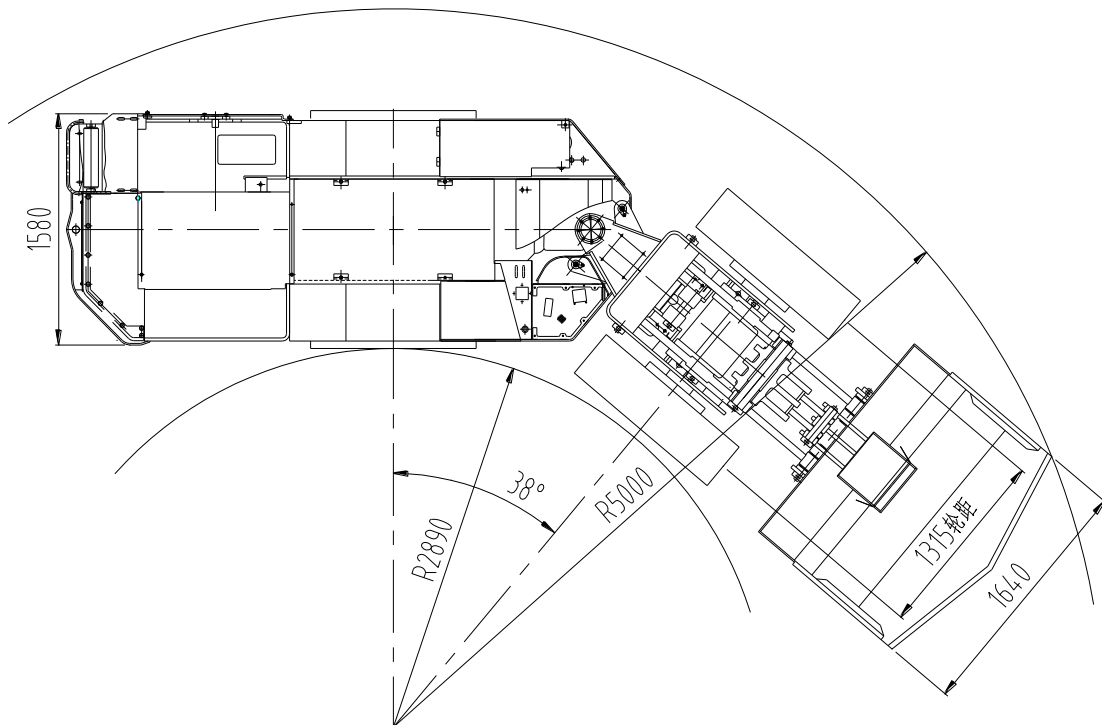
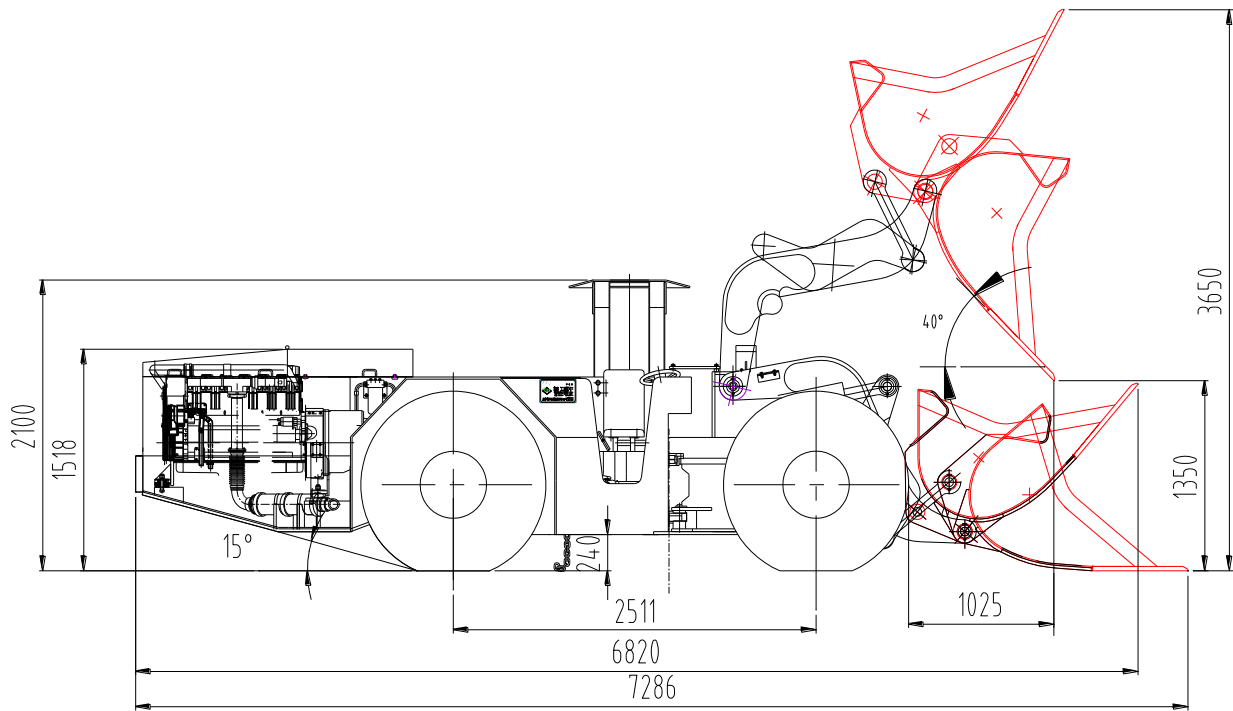

## Photo Gallery

